

PLAT OF SURVEY

PART OF THE SW 1/4 OF SECTION 10
TOWN 2 NORTH, RANGE 16 EAST
WALWORTH COUNTY, WISCONSIN

LEGAL DESCRIPTION
TAX PARCEL D-10-6

A PARCEL OF LAND LOCATED IN THE NORTHEAST 1/4 OF THE
SOUTHWEST 1/4 OF SECTION 10, TOWN 2 NORTH, RANGE 16
EAST, WALWORTH COUNTY, WISCONSIN, MORE PARTICULARLY
DESCRIBED AS FOLLOWS: BEGINNING AT A CONCRETE COUNTY
MONUMENT FOUND MARKING THE CENTER OF SAID SECTION 10;
THENCE ALONG THE EAST LINE OF SAID NORTHEAST 1/4 AND
THE CENTERLINE OF COUNTY TRUNK HIGHWAY "F", S 01DEG
27MIN 30SEC E, 950.73 FEET TO THE NORTHERLY RIGHT OF
WAY LINE OF INTERSTATE HIGHWAY "43"; THENCE ALONG SAID
RIGHT OF WAY, S 87DEG 50MIN 59SEC W, 276.38 FEET;
THENCE CONTINUE ALONG SAID RIGHT OF WAY, 762.91 FEET
ALONG THE ARC OF A CURVE TO THE LEFT HAVING A RADIUS OF
5929.58 FEET AND A CHORD WHICH BEARS S 84DEG 09MIN
50SEC W, 762.39 FEET; THENCE N 01DEG 21MIN 49SEC W,
1001.75 FEET TO THE NORTH LINE OF SAID NORTHEAST 1/4
AND THE CENTERLINE OF MARSH ROAD; THENCE ALONG SAID
NORTH LINE AND CENTERLINE, N 87DEG 57MIN 36SEC E,
1034.92 FEET TO THE POINT OF BEGINNING. THE ABOVE
DESCRIBED PARCEL CONTAINS 22.91 ACRES OF LAND, MORE OR
LESS.

LEGEND

- = FOUND IRON PIPE STAKE
- = FOUND IRON REBAR STAKE
- ⊠ = FOUND CONCRETE COUNTY MONUMENT
- = RECORD MONUMENT POSITION
- ⦿ = SET IRON REBAR STAKE
- △ = RIGHT OF WAY POST
- ◇ = POWER POLE
- (xxx) = RECORDED AS

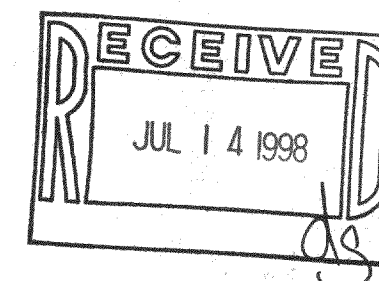

NOTE: COPIES OF THIS MAP TO WHICH THE FOLLOWING CERTIFICATE
WILL APPLY ARE BLUE LINE PRINTS SHOWING SURVEYOR'S ORIGINAL
SEAL AND SIGNATURE IN BLACK INK. COPIES BY ANY OTHER MEANS
MAY HAVE ALTERATIONS WHICH DO NOT REPRESENT THE SURVEYOR'S
WORK PRODUCT.

I HEREBY CERTIFY THAT THE ABOVE DESCRIBED PROPERTY HAS BEEN
SURVEYED UNDER MY DIRECTION AND THAT THE ABOVE MAP IS A TRUE
REPRESENTATION THEREOF AND SHOWS THE SIZE AND LOCATION OF
THE PROPERTY AND ITS EXTERIOR BOUNDARIES. THIS SURVEY IS
MADE FOR THE USE OF THE PRESENT OWNERS OF THE PROPERTY, AND
ALSO THOSE WHO PURCHASE, MORTGAGE, OR GUARANTEE THE TITLE
THEREIN WITHIN ONE YEAR FROM THE DATE HEREOF.

DATED: 6/26/98

PETER S. GORDON R.L.S. 2101

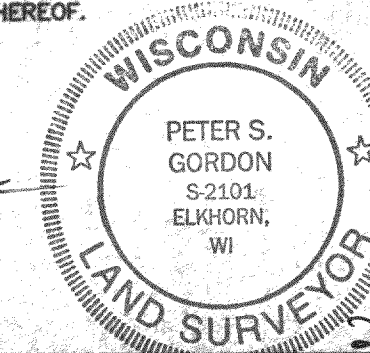

WORK ORDERED BY: KENT RAMM
RAM BRICK, INC.
140 S. HAYES AVE. PO BOX 9
LAGRANGE, IL 60525

FARRIS, HANSEN & ASSOCIATES, INC.
Engineering, Architecture, Surveying
7 Ridgway Court P.O. Box 437
ELKHORN, WISCONSIN 53121
Office: (414) 723-2098
Fax: (414) 723-5886

REVISIONS

PROJECT NO.
4890.98
DATE
06-23-98
SHEET NO.
1 OF 1

FD-10-6 KWP 226

FOUND PIPE
8.08' SOUTH
OF 33'
1/2 ROW

MARSH ROAD 66' WIDE

S 87°57'36" W 1034.92'

1001.97'

CENTER SECTION
10-2-16

COUNTY TRUNK HIGHWAY "F" 66' WIDE
S 01°27'30" E 950.73'

917.78'

D-10-6

22.91 AC
(22.13 AC. NET)

968.75'
N 01°21'49" W
1001.75'

WISCONSIN COORDINATE SYSTEM
SOUTH ZONE
GRID
NORTH

RAD = 5929.58' ARC = 762.91' CHD = 762.39' S 84°09'50" W
HIGHWAY ROW FENCE

243.38'
S 87°50'59" W
276.38'

33.0'

INTERSTATE HIGHWAY "43"

100 50 0 100 200 300 400
MAP SCALE IN FEET ORIGINAL 1" = 100'